

# 20 Platter Dolly



## **MATERIAL HANDLING APPLICATION:**

Used in Bakeries, Grocery Stores, Deli's and meat processing plants for material handling as well as display or storage. Available in End Load or Side Load, Stainless Steel or Aluminum, Fully Welded or Knocked-Down. Knock-Down version will save on shipping and handling charges and includes tool needed for easy assembly. All are equipped with 5" swivel casters (2 with brake, 2 without brake). Sold without platters.

## **AVAILABLE OPTIONS:**

- » Fiberglass Platter
- » Aluminum Platter
- » Stainless Steel Platter

## **MATERIAL CONSTRUCTION:**

All our Platter Dollies are manufactured with heavy duty 1" square tube and are stable for storage or transportation of 18" x 26" Platters. Your choice of rustproof material: Stainless Steel or Aluminum. Features End Loaded or Side Loaded design with twenty levels and spacing between platters of 2-7/8".



**Aluminum, Fully Welded, End Load # DL102018**



**Aluminum, Fully Welded, Side Load # DL102019**

**Manufactured by:**

**DC TECH INC.**

619 E 19th Street  
Kansas City, MO 64108-1743

**Toll Free: 877-742-9090**

**Fax: 816-842-4121**

**www.dctech-inc.com**  
**sales@dctech-inc.com**

*Note: You may print this with your company name and address as "Distributed By:" in place of our information above. See the PDF logo at the bottom of each page on our website.*

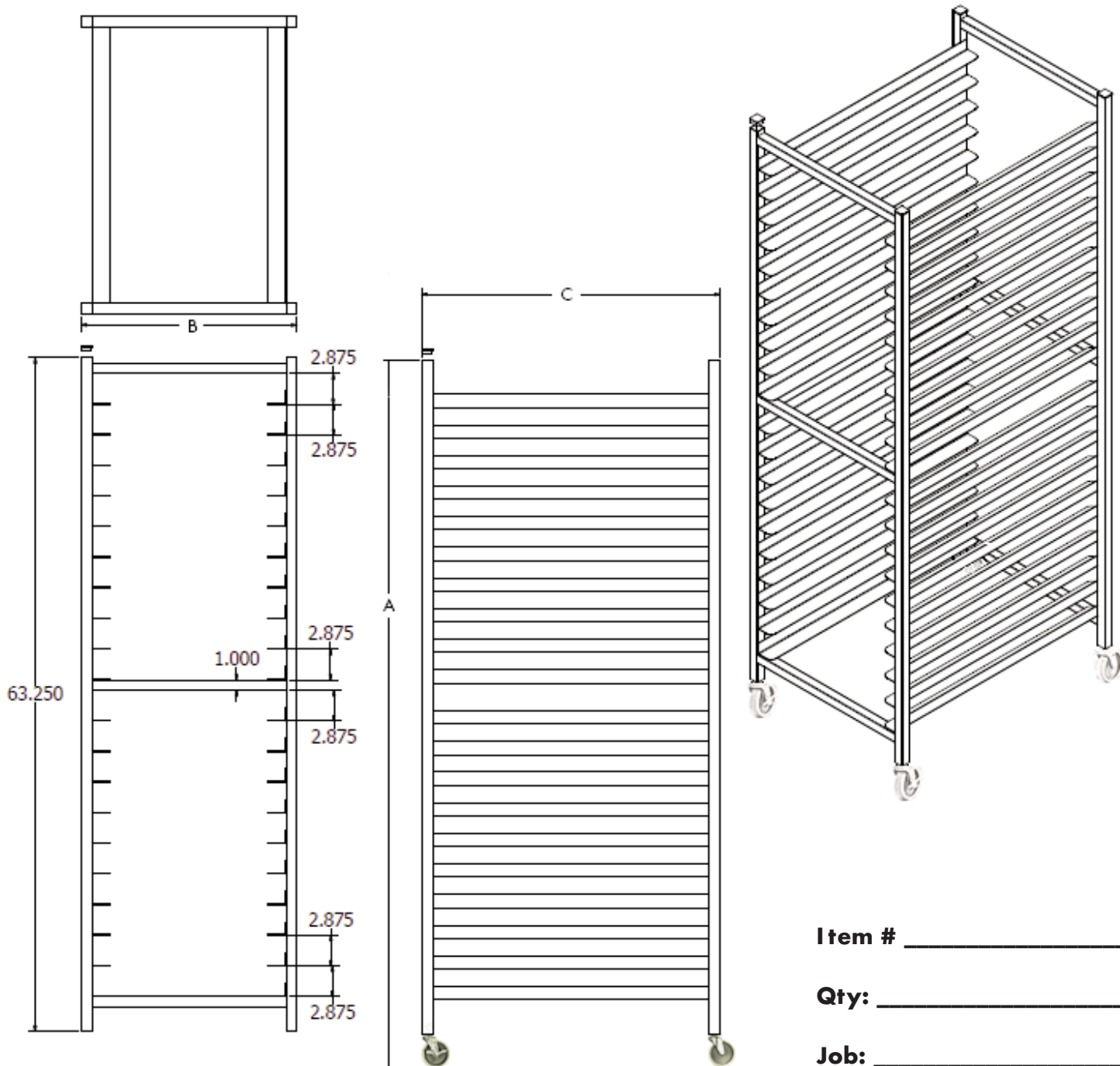

Item # \_\_\_\_\_  
 Qty: \_\_\_\_\_  
 Job: \_\_\_\_\_

Model #	Description	"A" Height	"B" Width	"C" Length	"D" Spacing
DL102018	End Load 20 Platter Dolly - Aluminum - Fully Welded	69.5"	20.25"	28"	2.875"
DL101013	End Load 20 Platter Dolly - Stainless Steel - Knock-Down	69.5"	20.25"	28"	2.875"
DL102019	Side Load 20 Platter Dolly - Aluminum - Fully Welded	69.5"	20.25"	28"	2.875"
DL101014	Side Load 20 Platter Dolly - Stainless Steel - Knock-Down	69.5"	20.25"	28"	2.875"

**Manufactured by:**  
**DC TECH INC.**

619 E 19th Street  
 Kansas City, MO 64108-1743

Toll Free: 877-742-9090  
 Fax: 816-842-4121  
[www.dctech-inc.com](http://www.dctech-inc.com)  
[sales@dctech-inc.com](mailto:sales@dctech-inc.com)

© 2016 DC TECH INC. - ALL RIGHTS RESERVED ♦ DC Tech Inc., reserves the right to modify or make changes at any time without notice.